

DY2008 Distance-Based Pattern Controller

Used in conjunction with your hot or cold glue adhesive applicator, the DY2008 from ITW Dynatec accurately controls adhesive output, reducing waste and improving consistency of production. The unit can be configured to independently control 4 to 128 glue applicator heads in a wide variety of adhesive patterns. Each channel can operate in one of several distance-based modes: glue beads, dots, continuous gluing, random product length, and stitching. The adhesive application can be triggered with a photo eye, proximity switch, or by exceeding a certain machine speed.

DY2008 Distance-Based Pattern Controller:

- 4–128 channels with 16 patterns per channel.
- Memory for 60 programs.
- Easily navigable menu structure.
- Machine speeds to 1200m/min (4000fpm) @0.5mm (.02”).
- Modes include standard, continuous, and random length.

Performance

Trigger inputs for each channel allows user to accurately control each glue pattern.

Simplicity

Easy-to-navigate user interface allows for simple set up and operation.

Flexibility

Independently control up to 128 glue applicators using up to 4 speed inputs and up to 4 pressure control outputs.



DY2008 Distance-Based Pattern Controller

The Dynatec *Difference*

Switch to Stitch and Save

Replace a 6" continuous adhesive bead with a 6" skip pattern, and you cut adhesive consumption by up to 50%. It's simple, and the savings are certain. The DY2008 also goes the extra mile with a built-in algorithm that always ends an event with

glue when using a stitch pattern so the edge is never "skipped". Make the switch today and see the savings for yourself!

Specifications	DY2008
Operating Temperature	0°C to 50°C (32°F to 122°F)
Storage Temperature	0°C to 50°C (32°F to 122°F)
Number of Channels (increments of 4)	4 - 128
Number of Programs	60
Number of Events per Program	16
Output Voltage	24VDC
Output Wattage	20 watts per channel
Number of Triggers	1 per channel
Trigger Power Supply	24VDC nominal
Trigger Input Signal	NPN/PNP or contact closure
Max. Adjustable Range	0 - 800 mm (80 in) 1 mm increments (.01" in increments)
Power Supply	120, 200 or 240VAC 50/60 Hz, L1/N/PE
Input Power	180w (8 channel version)

Related Products

- Melters
- Feed Systems
- Hoses
- Applicators
- Nozzles



Dimensions	DY2008
Height (H)	15 cm (5.9 in)
Depth (D)	34.5 cm (13.6 in)
Width (W)	32.6 cm (12.8 in)

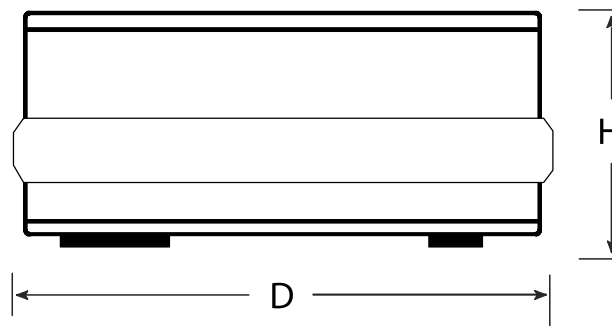
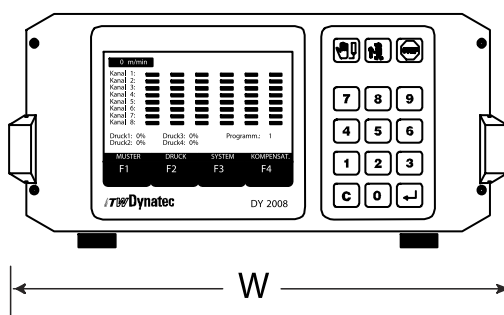

CHINA

ITW Dynatec Suzhou
Unit2, B1 Building
No.9 Weixin Road
SIP, Suzhou, China 215122
Telephone +86.512.6289.0620
Fax +86.512.6289.0621
dynatecsuzhou@itwdynatec.cn

AMERICAS

ITW Dynatec
31 Volunteer Drive
Hendersonville, TN 37075
Telephone 615-824-3634
+1.800.860.6150
Fax +1.615.264.5248
dynatec@itwdynatec.com

JAPAN

ITW Dynatec K.K.
Tsukimura Building 5th Floor
26-11, Nishikamata 7-chome
Ota-ku, Tokyo 144-0051, Japan
Telephone +81.3.5703.5501
Fax +81.3.5703.5505
info@itwdynatec.co.jp

EUROPE, AFRICA & MIDDLE EAST

ITW Dynatec GmbH
Industriestrasse 28
D-40822 Mettmann, Germany
Telephone +49.210.4915.0
Fax +49.210.491.5111
e.mail@itwdynatec.de

ITW Dynatec TenPlus
ZI Croix de Raville
28500 Cherisy, France
Telephone +33(0)2.37.62.56.47
Fax +33(0)2.37.62.56.40
info@itwdynatec.fr